

## Removal and Installation

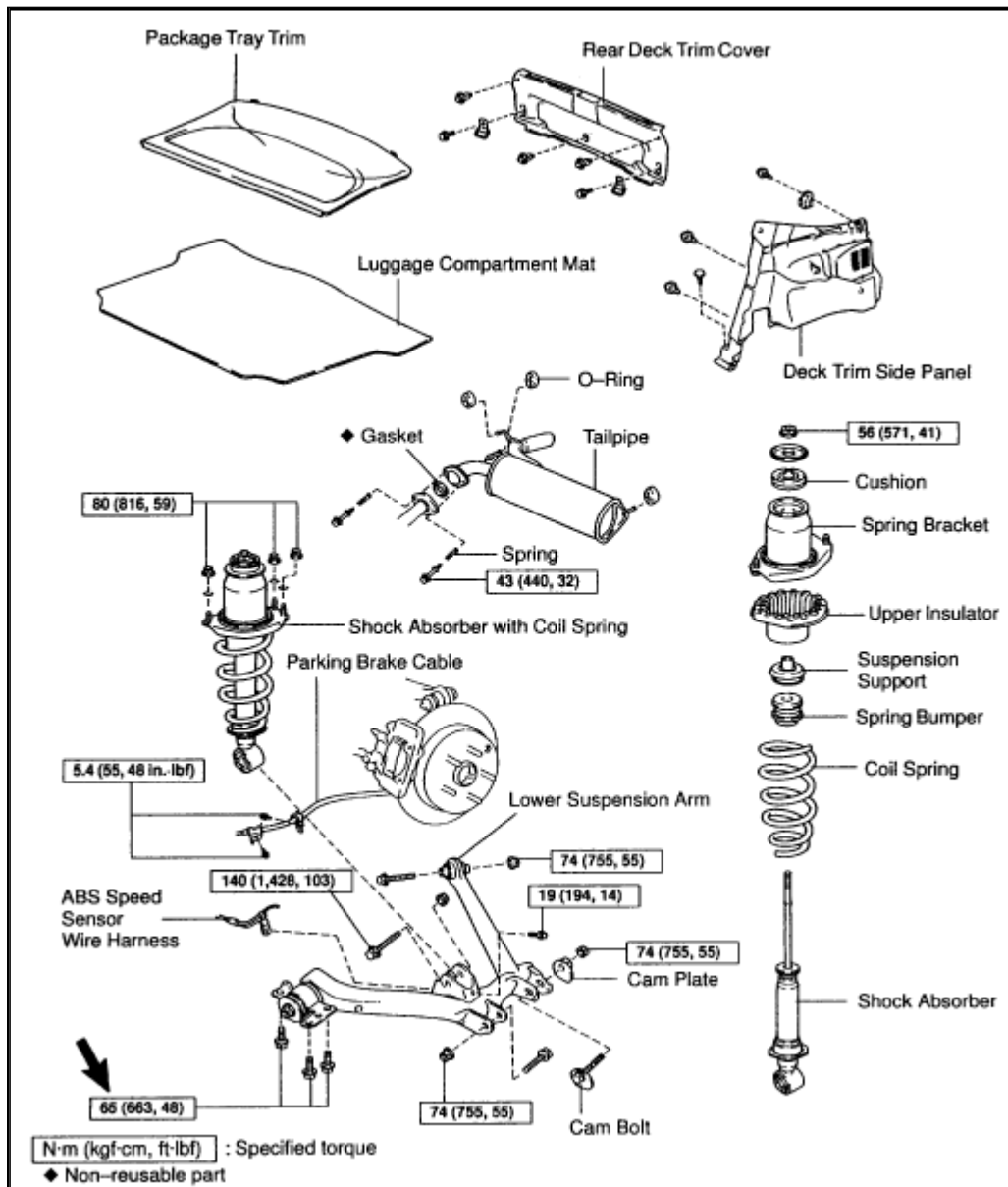

ZOOM

SIZED FOR PRINT

## REMOVAL

1. REMOVE REAR [WHEEL](#) Torque: 103 Nm (1,050 kgf.cm, 76 ft. lbs.)
2. REMOVE PACKAGE TRAY TRIM
3. REMOVE LUGGAGE COMPARTMENT MAT
4. REMOVE REAR DECK TRIM COVER
5. REMOVE DECK TRIM SIDE PANEL
6. REMOVE REAR LOWER SUSPENSION ARM

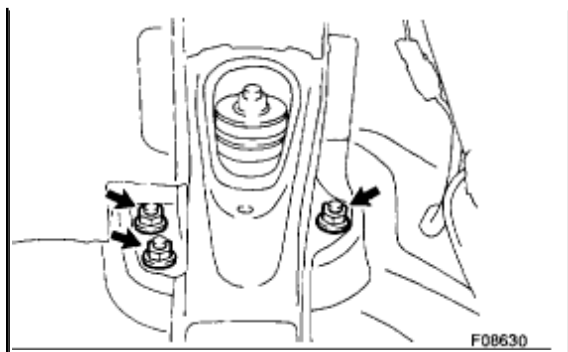

ZOOM

SIZED FOR PRINT

7. REMOVE REAR [SHOCK ABSORBER](#) Remove the 3 nuts and rear shock absorber. Torque: **80 Nm (816 kgf.cm, 59 ft. lbs.)**

### INSTALLATION

Installation is in the reverse order of removal.

**HINT:** After installation, check the rear [wheel](#) alignment.